

Notice de montage armoire **NIELS**

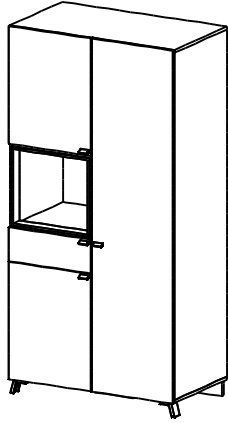

Réf. 505025 orme clair/rouge

Réf. 505054 orme clair/bleu

ALSAPAN

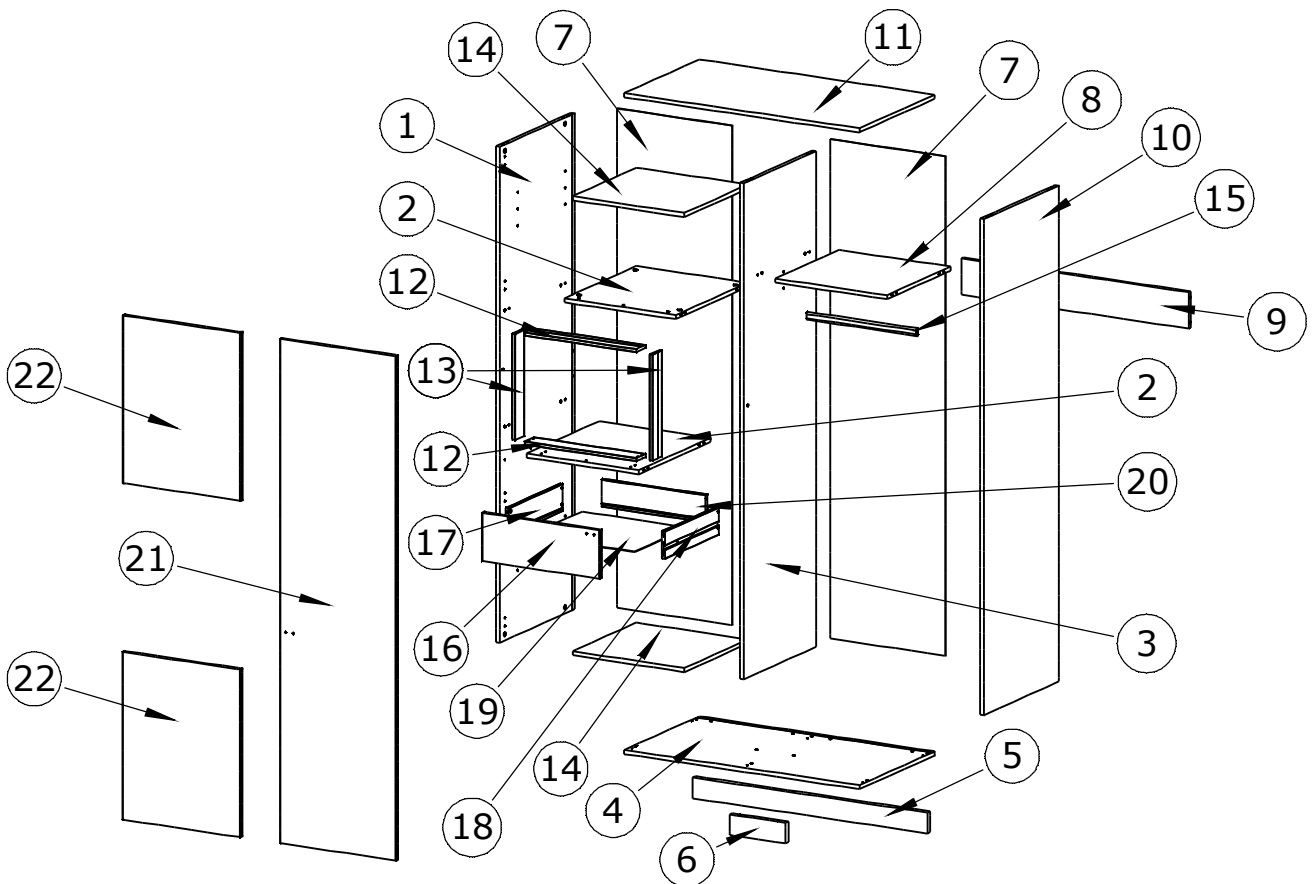

N°	Dimensions	Colis	N°	Dimensions	Colis	N°	Dimensions	Colis
1	1910x557x16 mm	3/3	10	1910x557x16 mm	3/3	19	458x400x3 mm	1/3
2	480x536x16 mm	1/3	11	1010x559x16 mm	1/3	20	447x105x12 mm	1/3
3	1910x537x16 mm	2/3	12	408x70x12 mm	1/3	21	1942x499x16 mm	2/3
4	1010x559x16 mm	1/3	13	408x70x12 mm	1/3	22	646x507x16 mm	2/3
5	1008x80x22 mm	1/3	14	480x474x16 mm	1/3	23		./.
6	240x80x22 mm	1/3	15	472x30x15 mm	1/3	24		./.
7	1923x494x3 mm	3/3	16	507x186x16 mm	1/3	25		./.
8	480x474x16 mm	2/3	17	401x105x12 mm	1/3	26		./.
9	976x140x16 mm	1/3	18	401x105x12 mm	1/3	27		./.



		500617 		52259 	
		28x 504029 		28x	
		30046 		35838 	
		2x		2x	
		2001179 		2001190 	
		8x		8x	
		2007285 		433026 	
		4x		20x	
		465179 		2001117 	
		6x		1x	
		2063331 		505937 	
		4x		52563 	
430654 		505075 rouge 505079 bleu 		481660 	
2x		2x		7x	
505081 rouge 505085 bleu 		52140 		494527 	
4x		1x 2 pièces		7x	
				501917 	
				1x 4 pastilles	

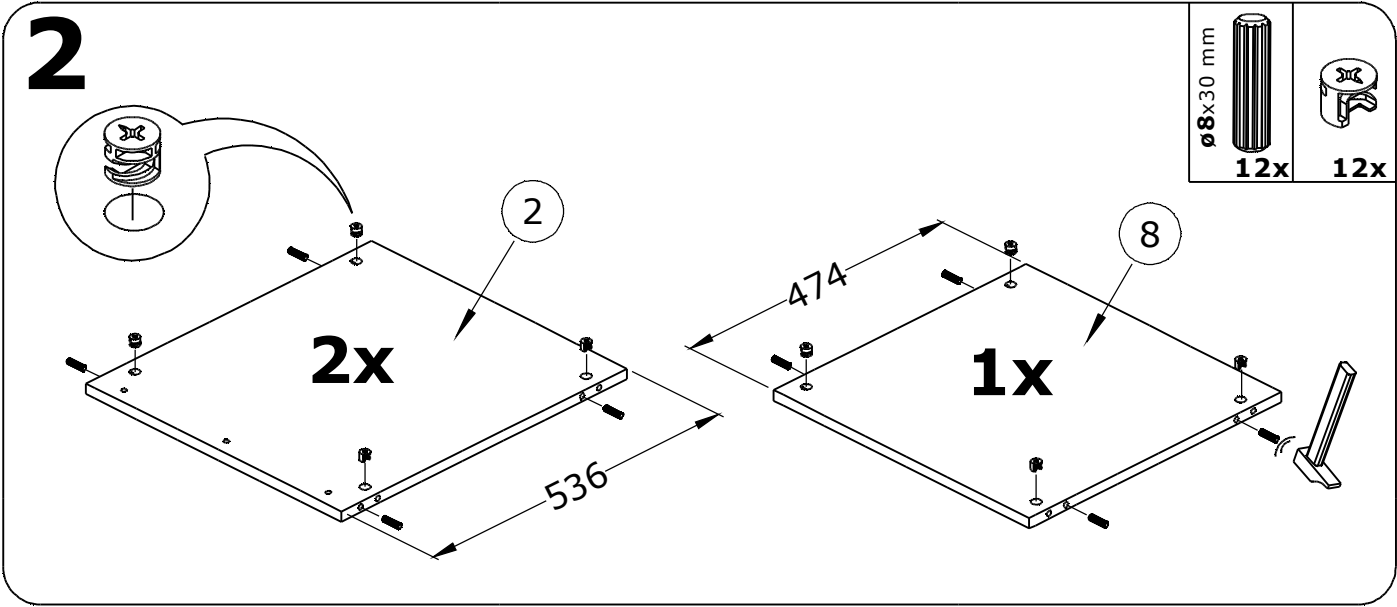
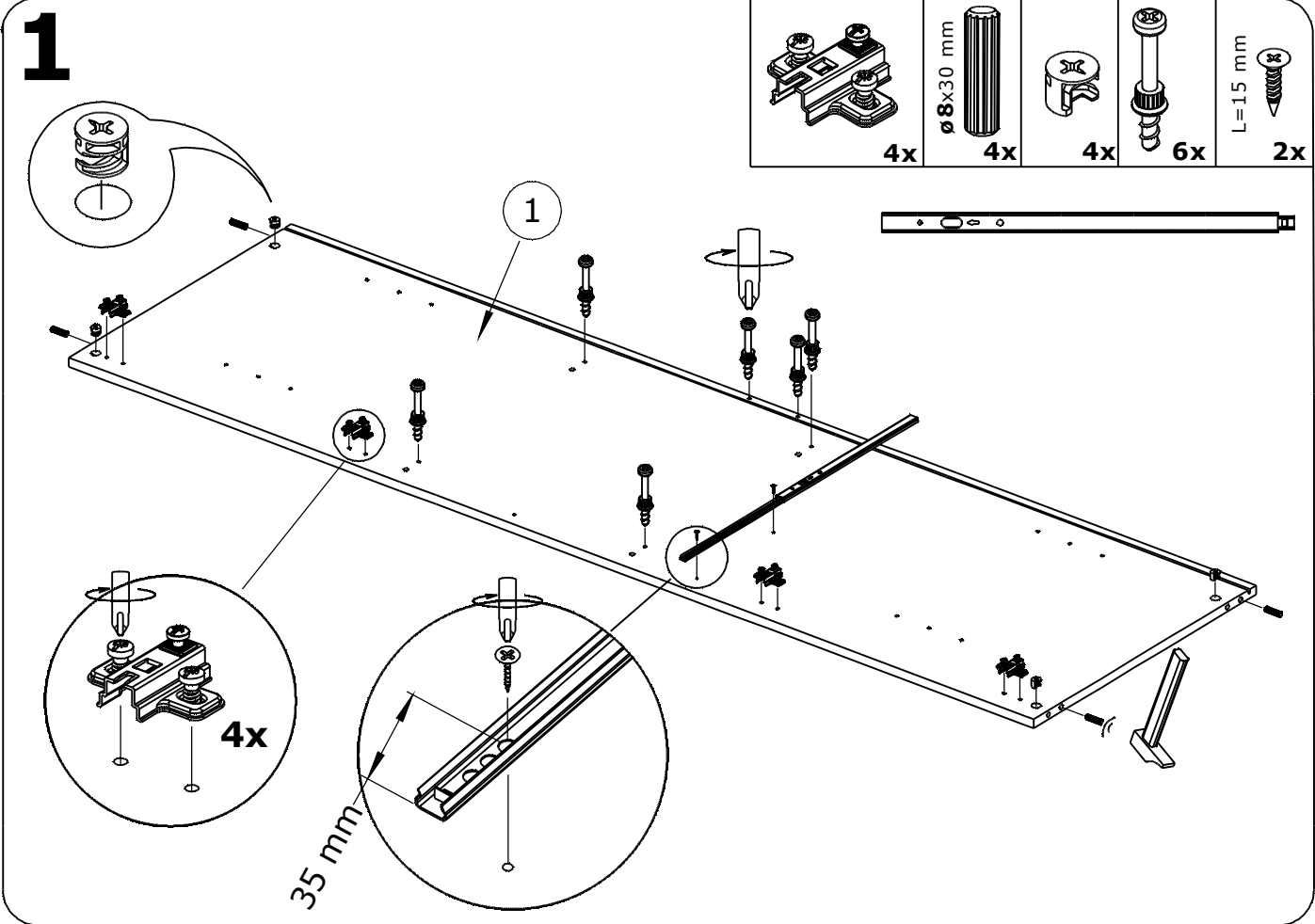
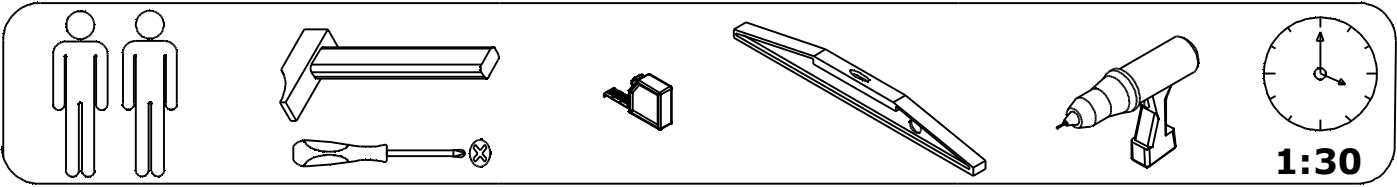

3

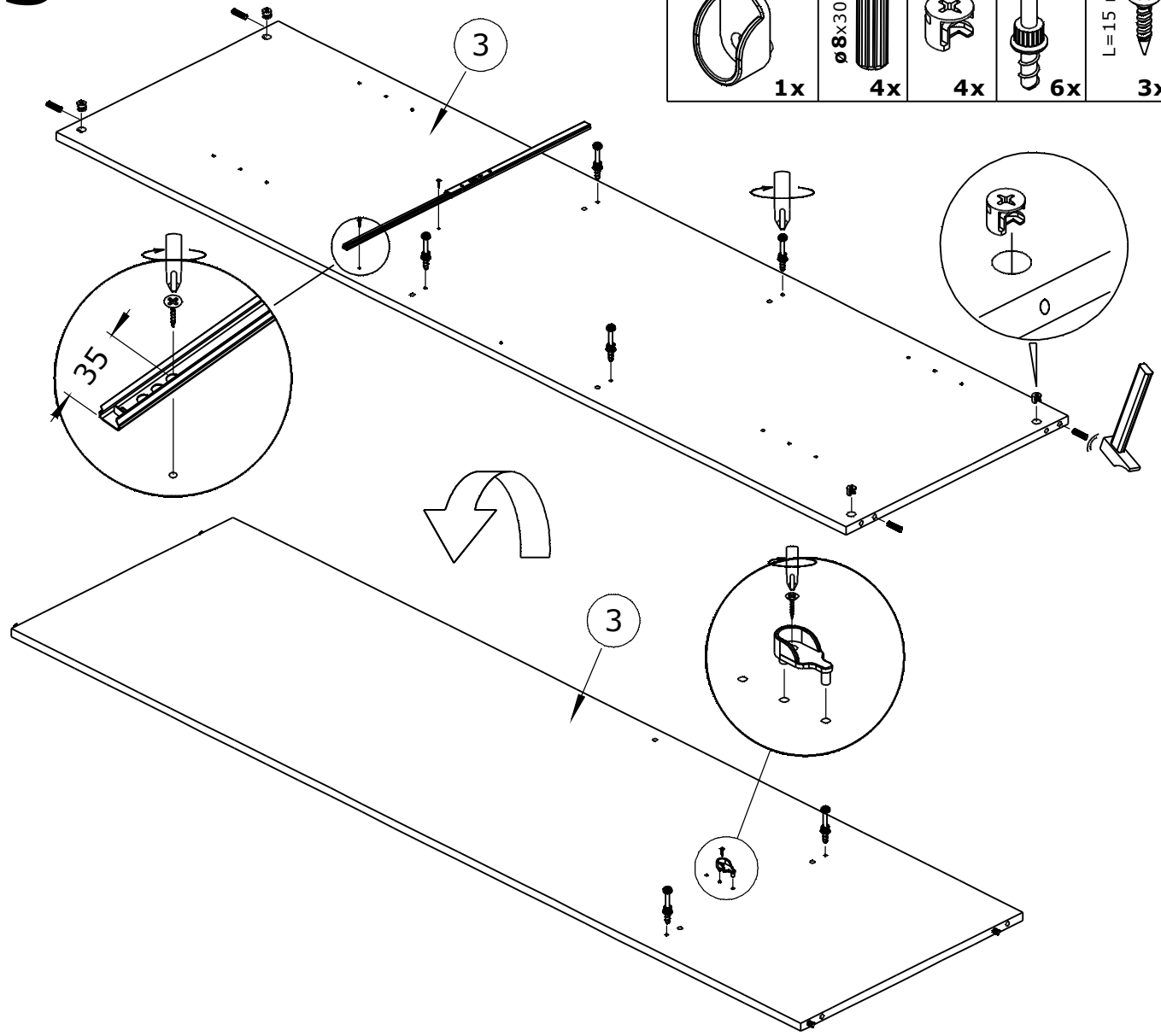
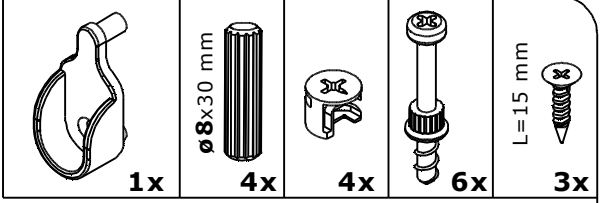

4

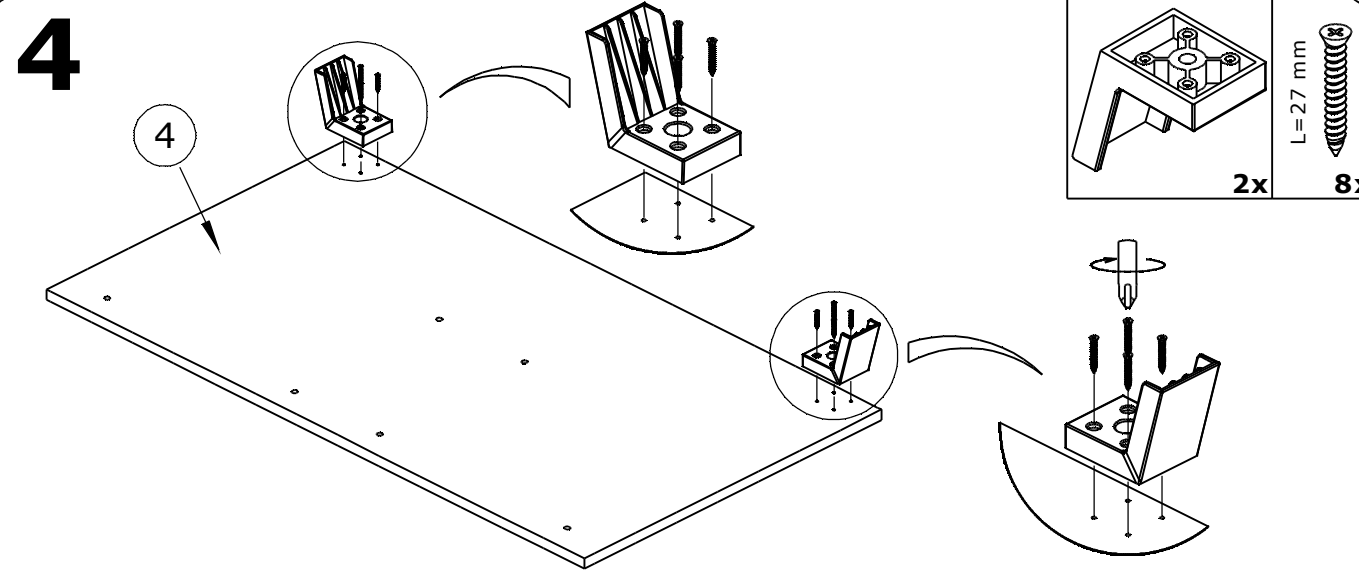
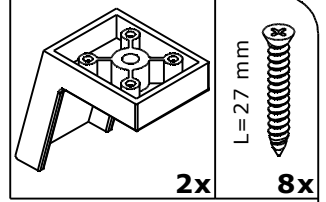

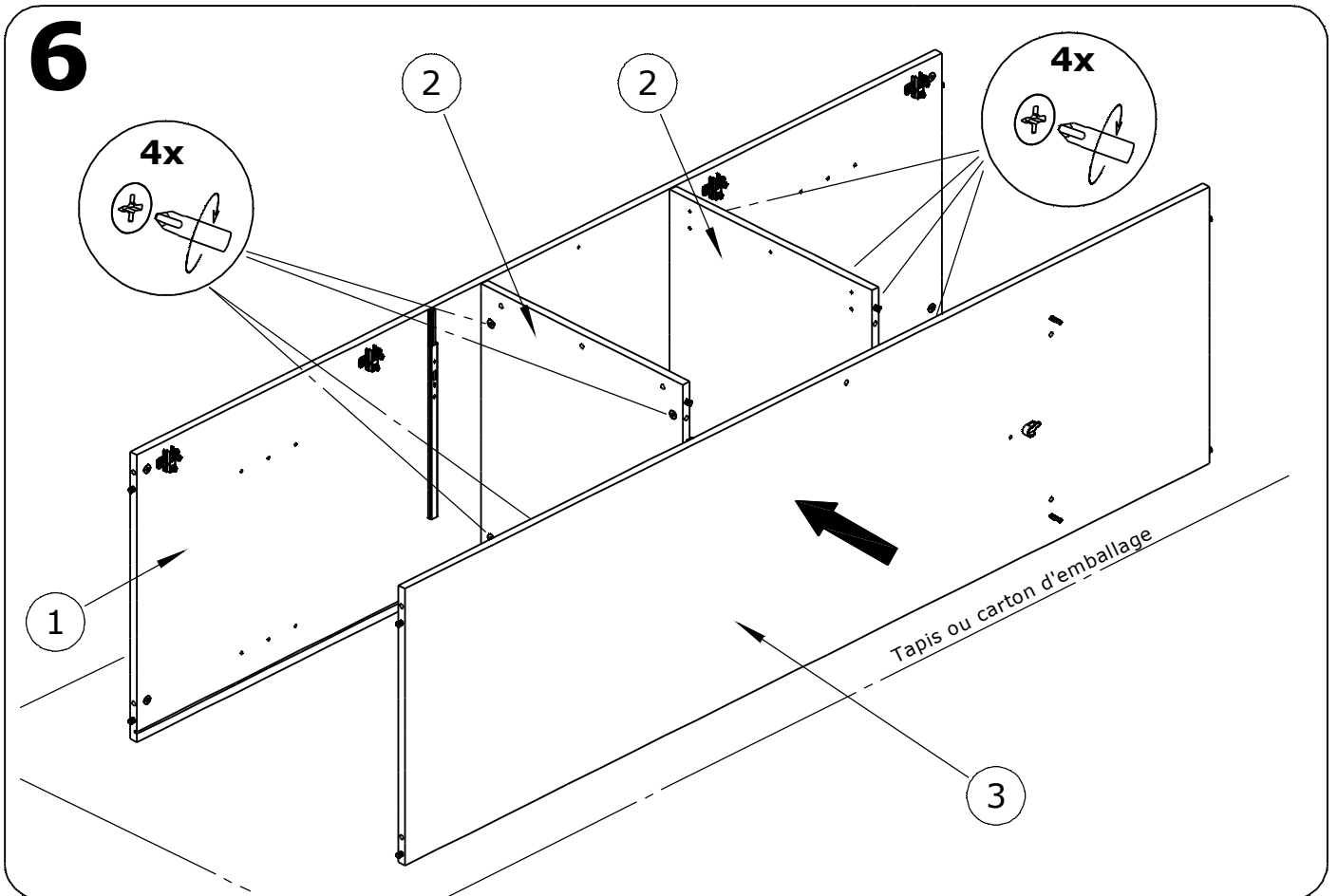
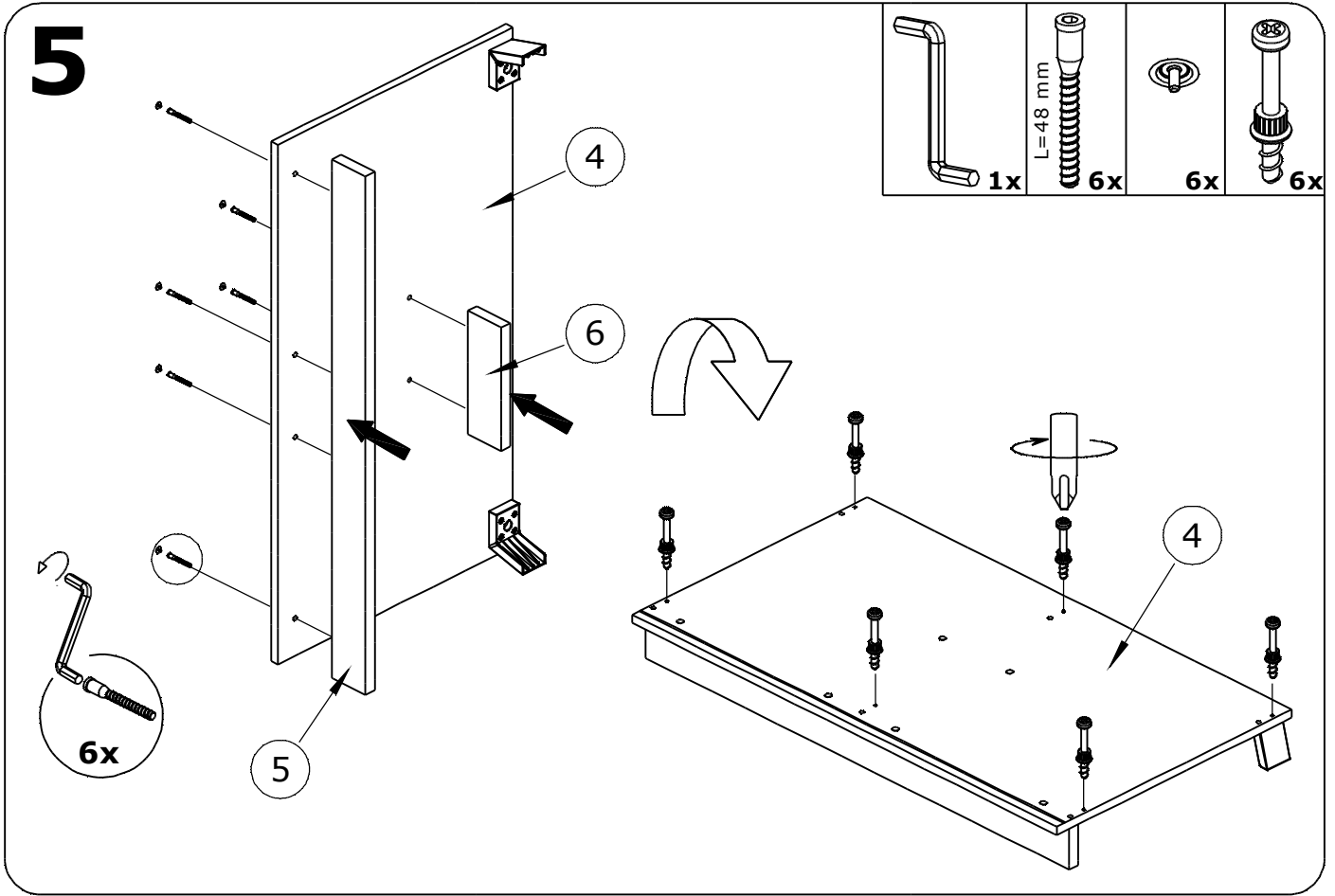

7

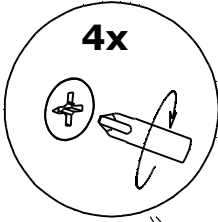

4

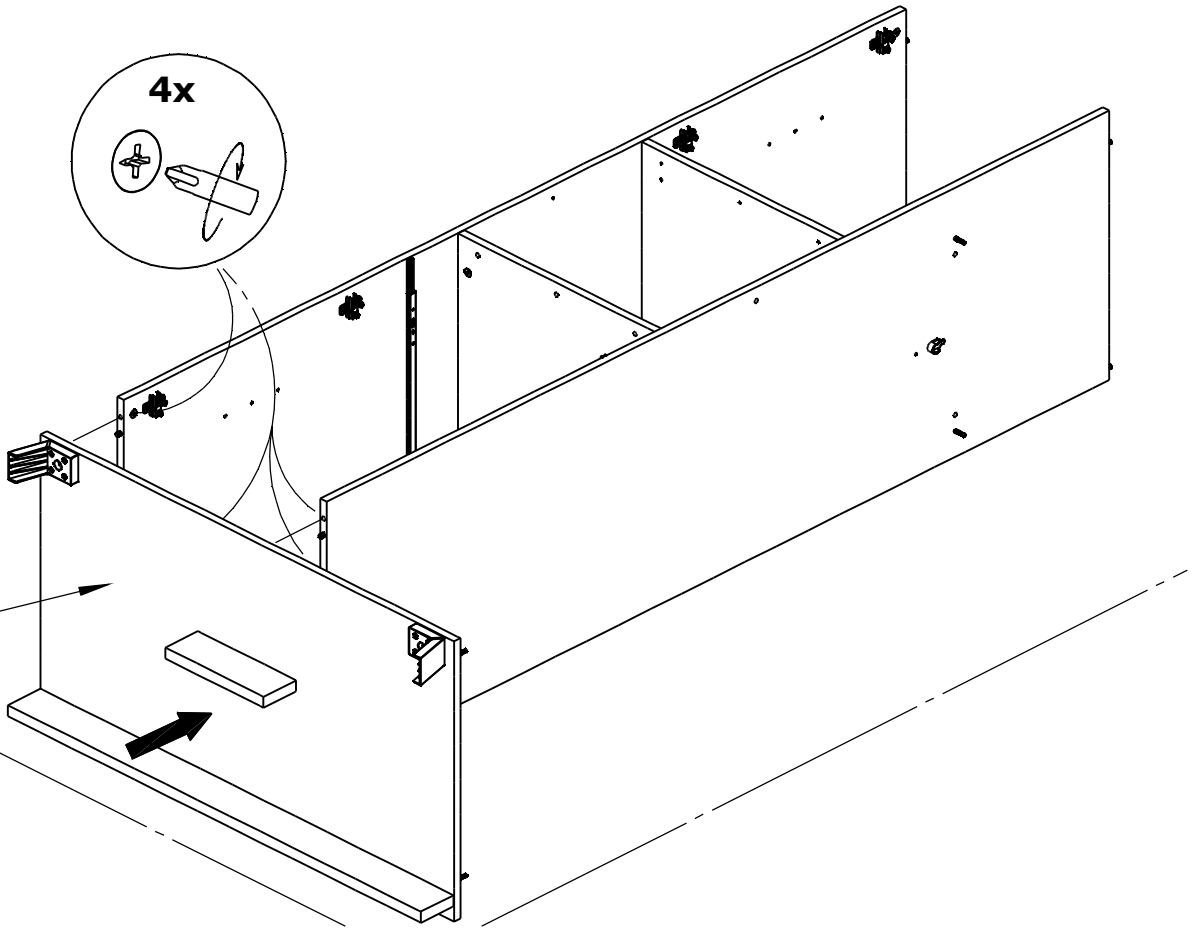

8

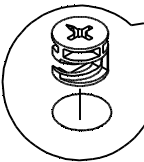
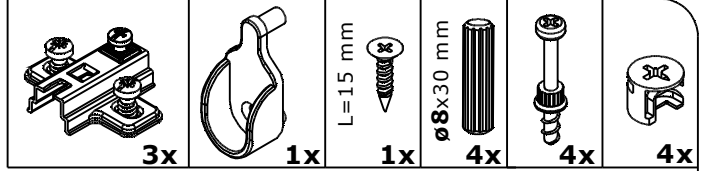

10

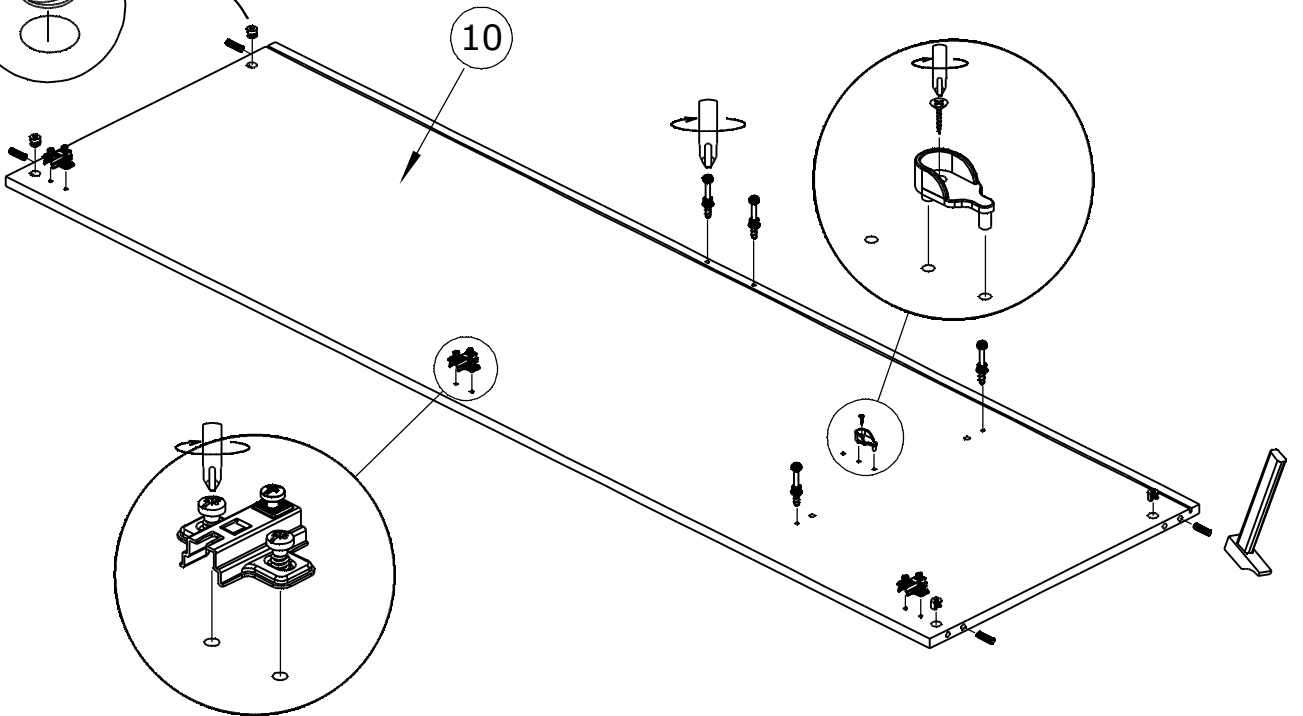

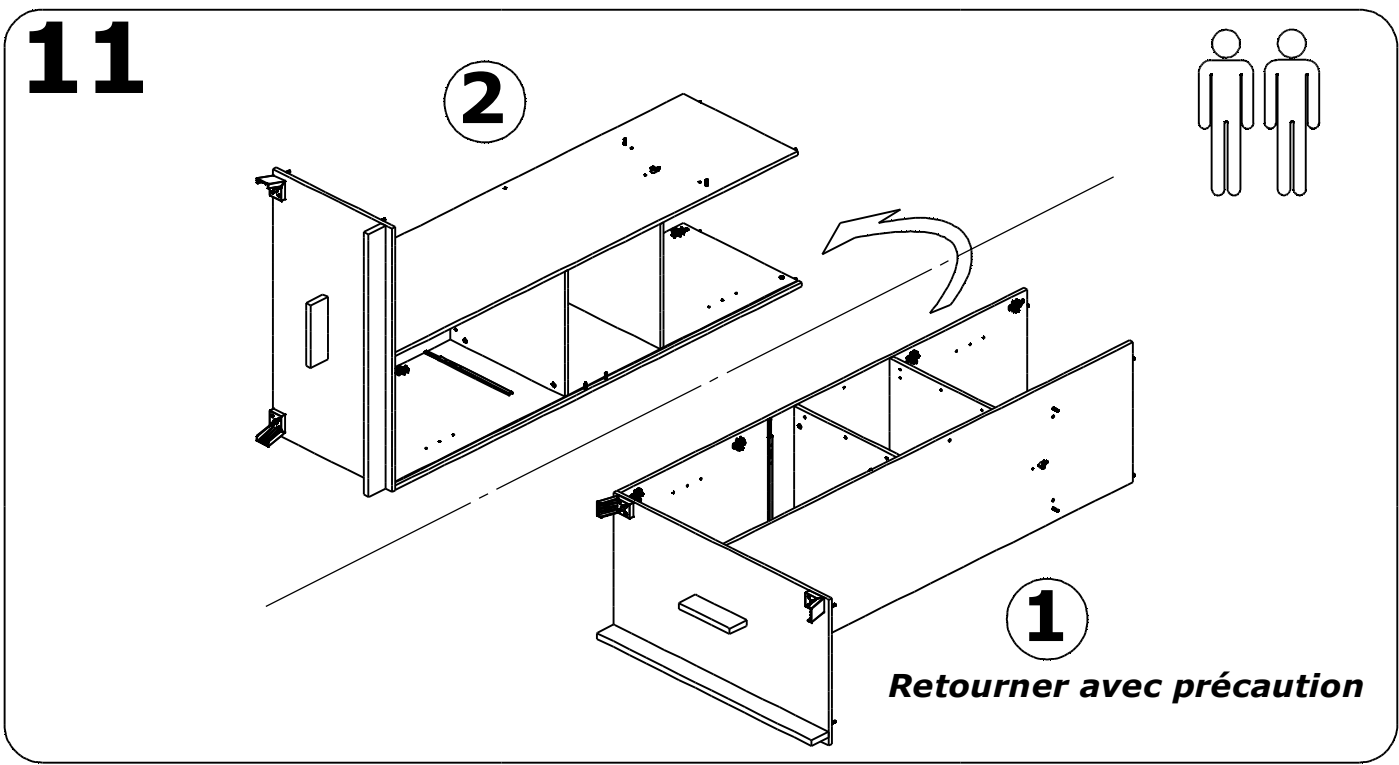
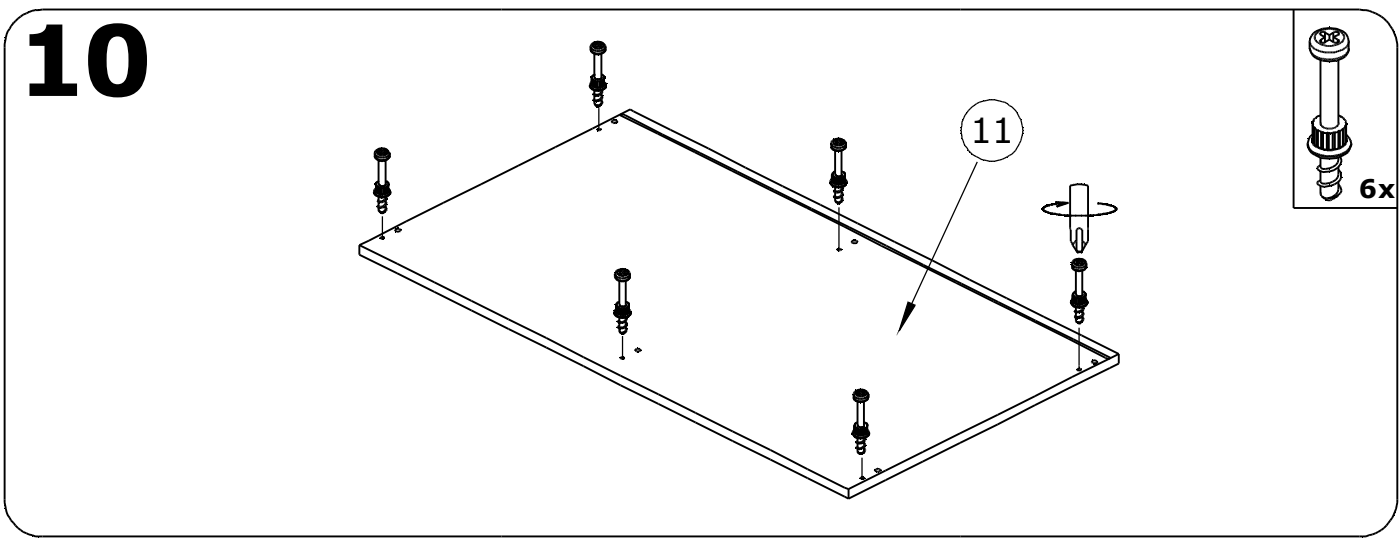
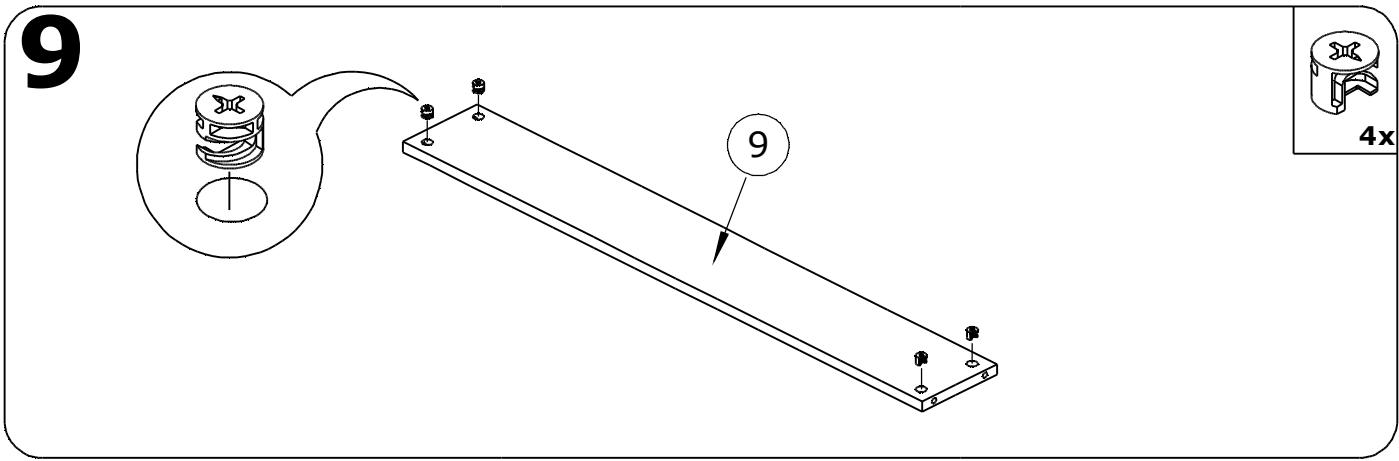

12

Chant

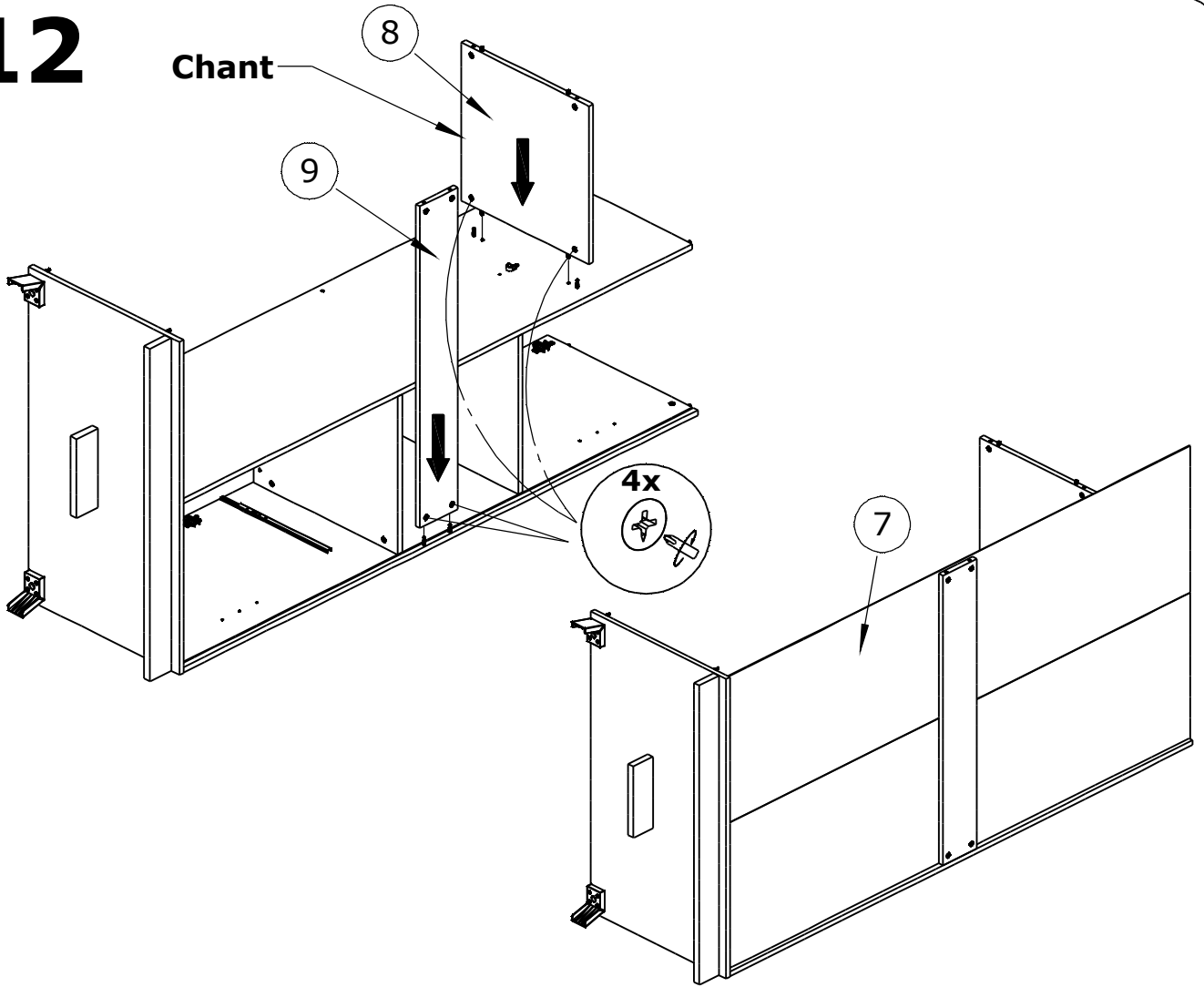

13

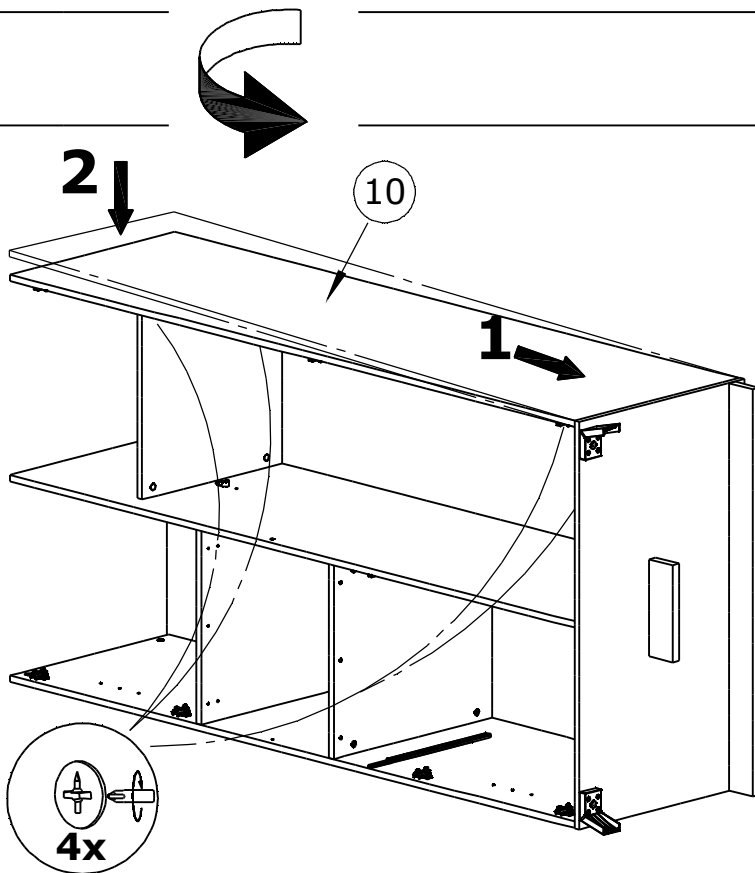
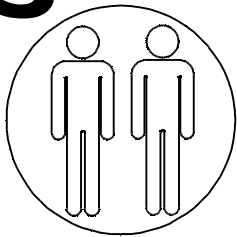

14

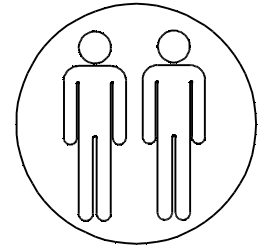
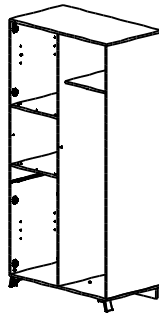
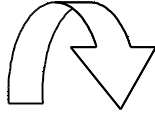
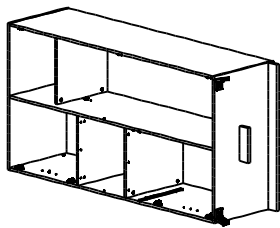
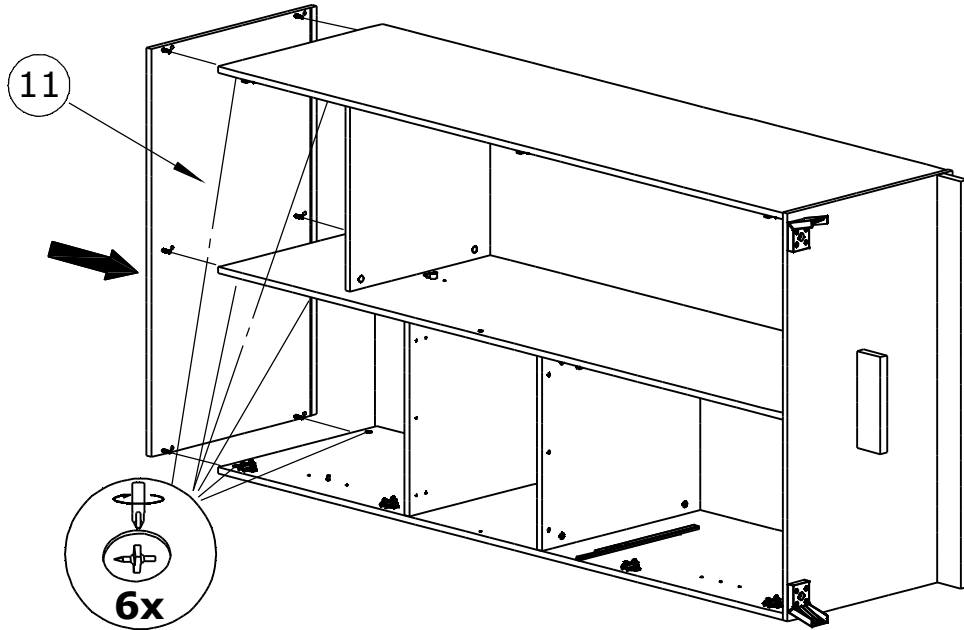

Relever avec précaution

15

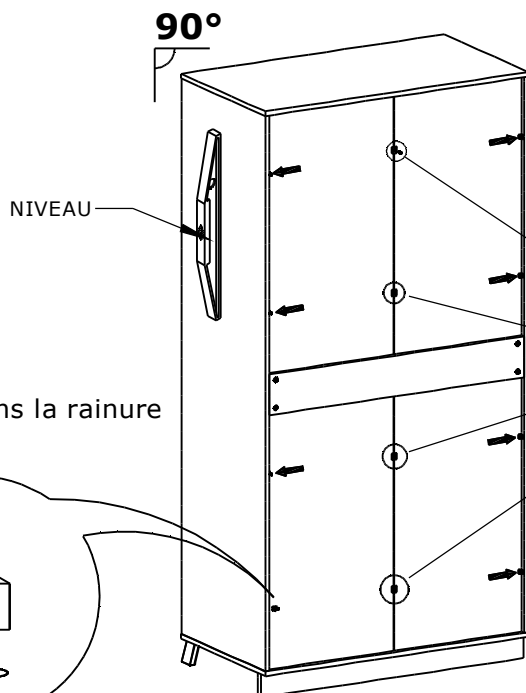

1 Insérer dans la rainure
2 Fixer

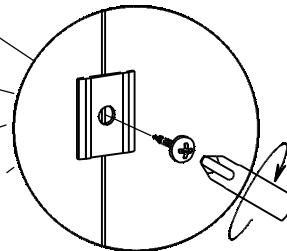
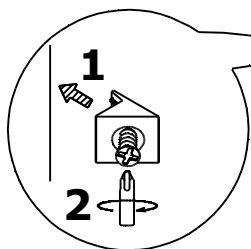

ATTENTION !
Sens

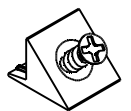

8x

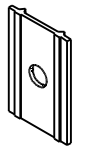

4x



4x

16

1 Pointer
2 Visser

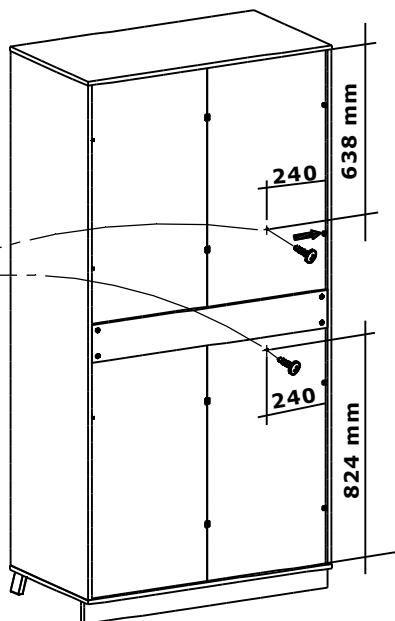
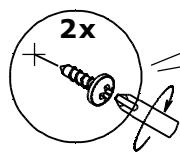

L=15 mm



2x

17

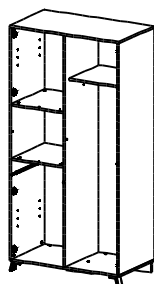

1 Tracer

FIXATION MURALE

ATTENTION !
Chevilles et vis de fixation
murales **NON FOURNIES.**

SANGLE ANTI-BASCULEMENT

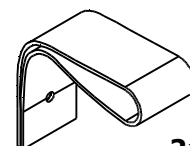

2x

2 Fixer au mur

5 cm en dessous du traçage

3 Fixer au meuble

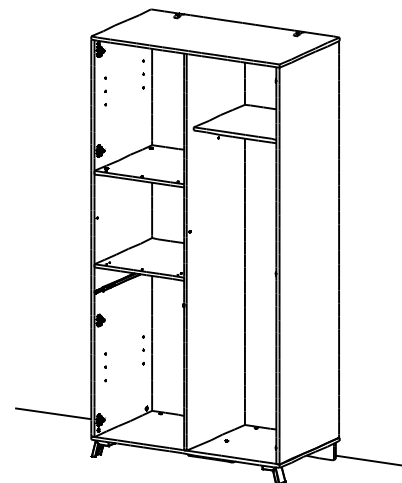
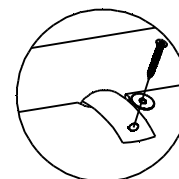
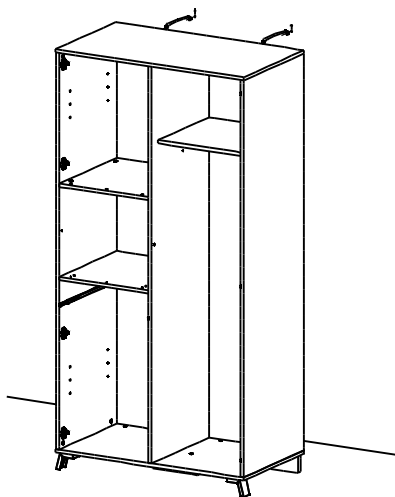
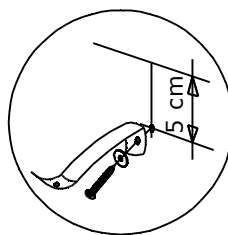
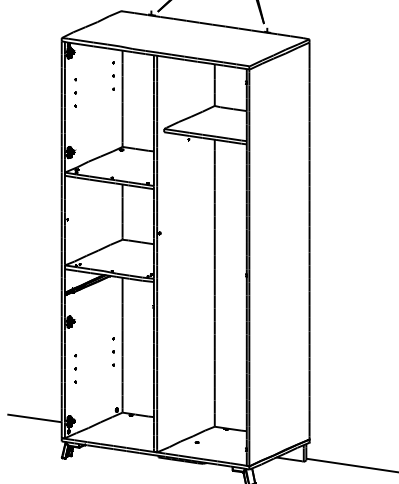
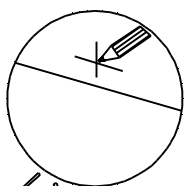

18

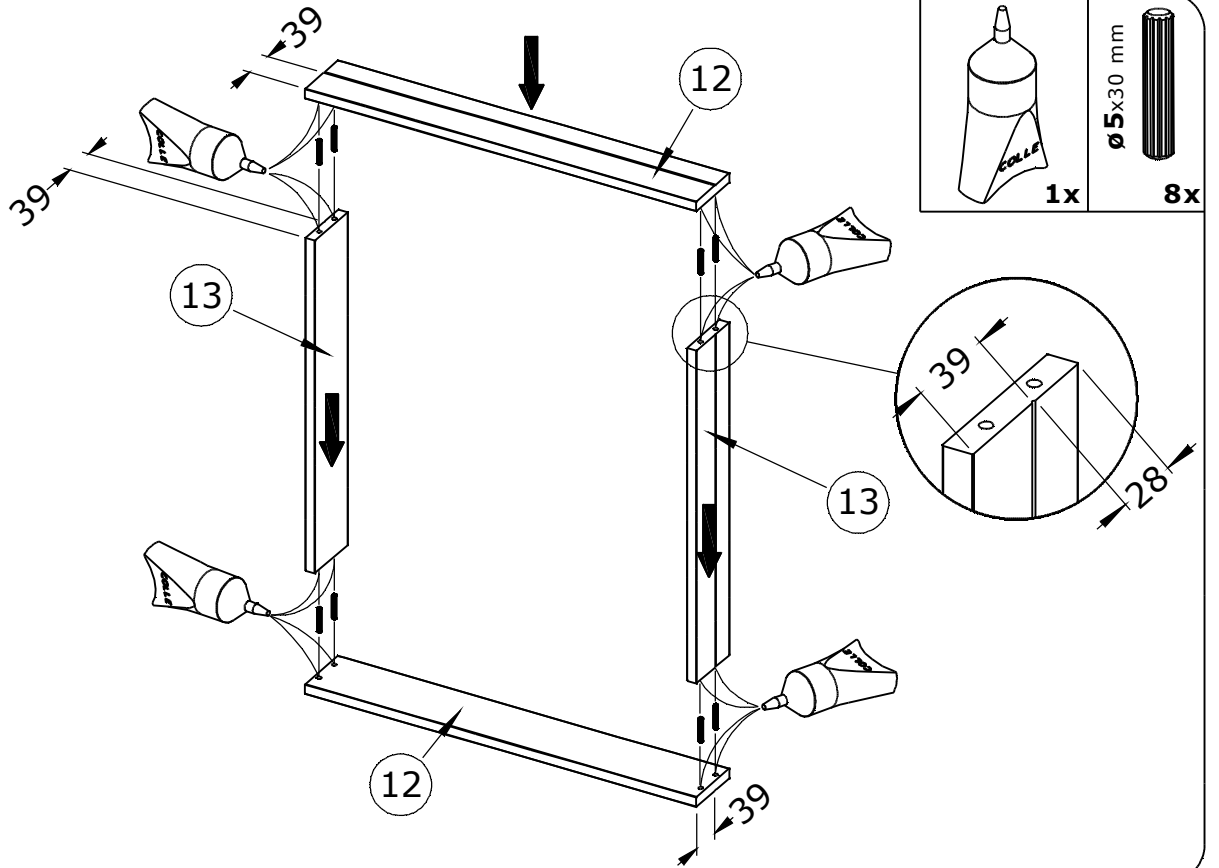

19

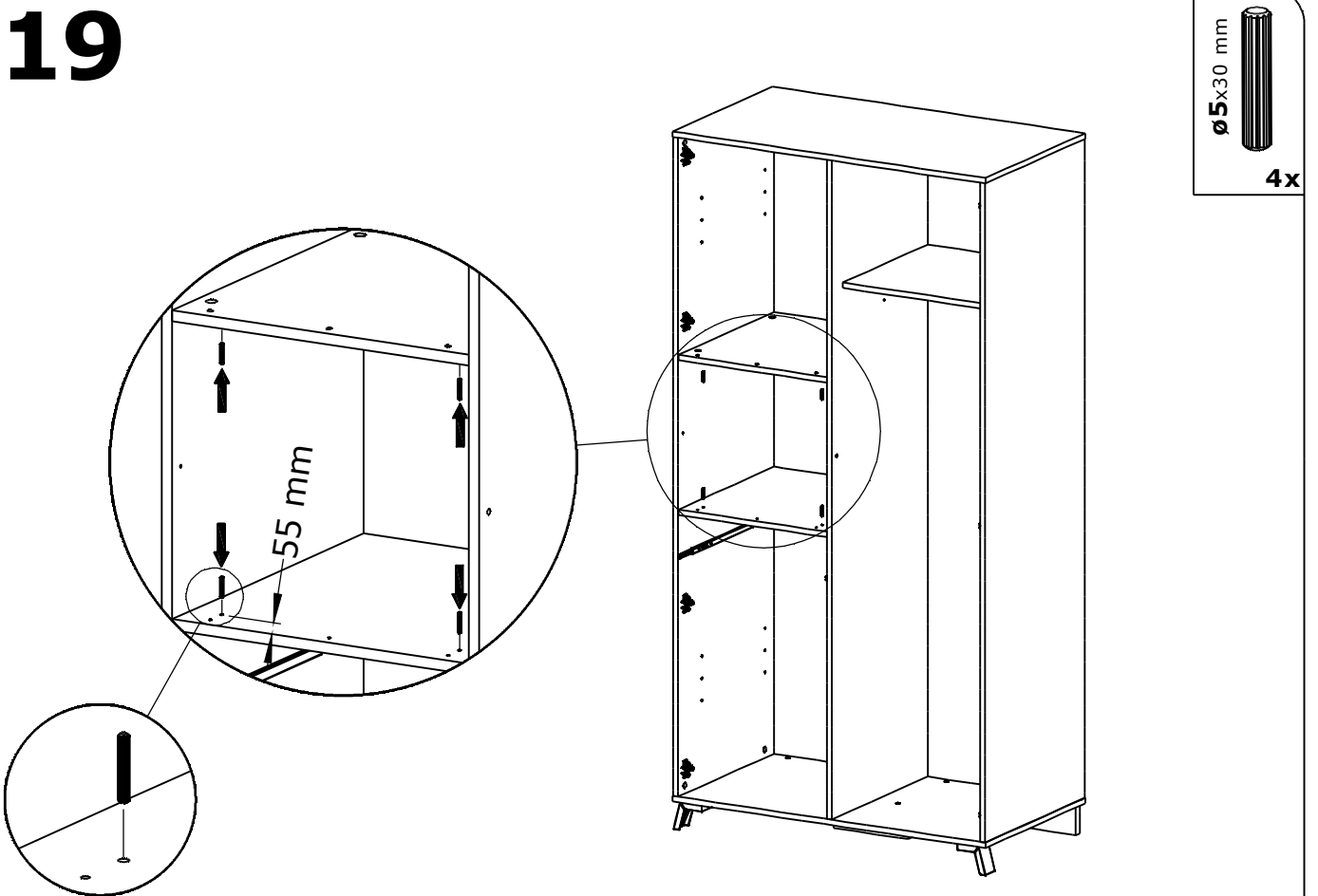

20

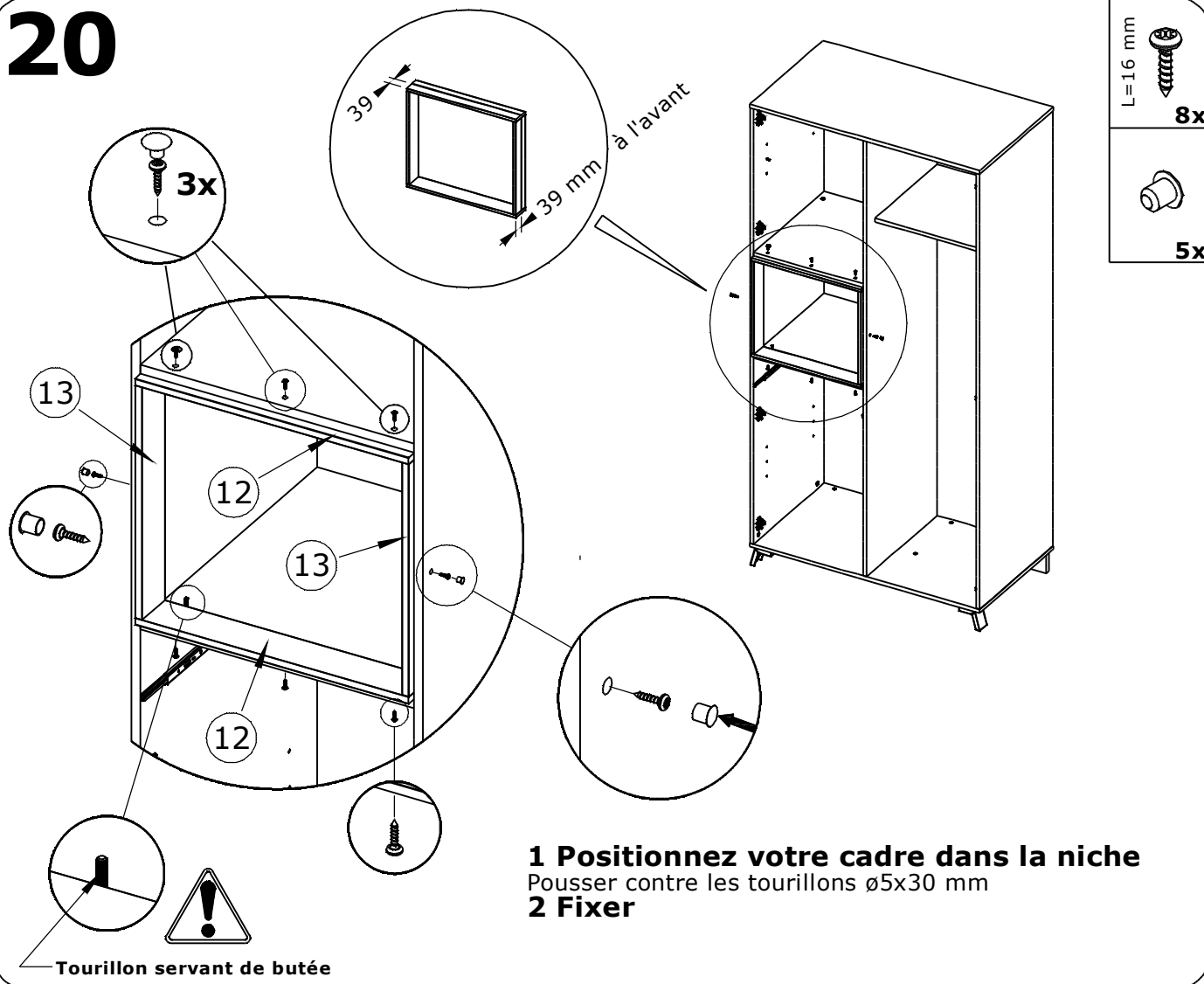

21

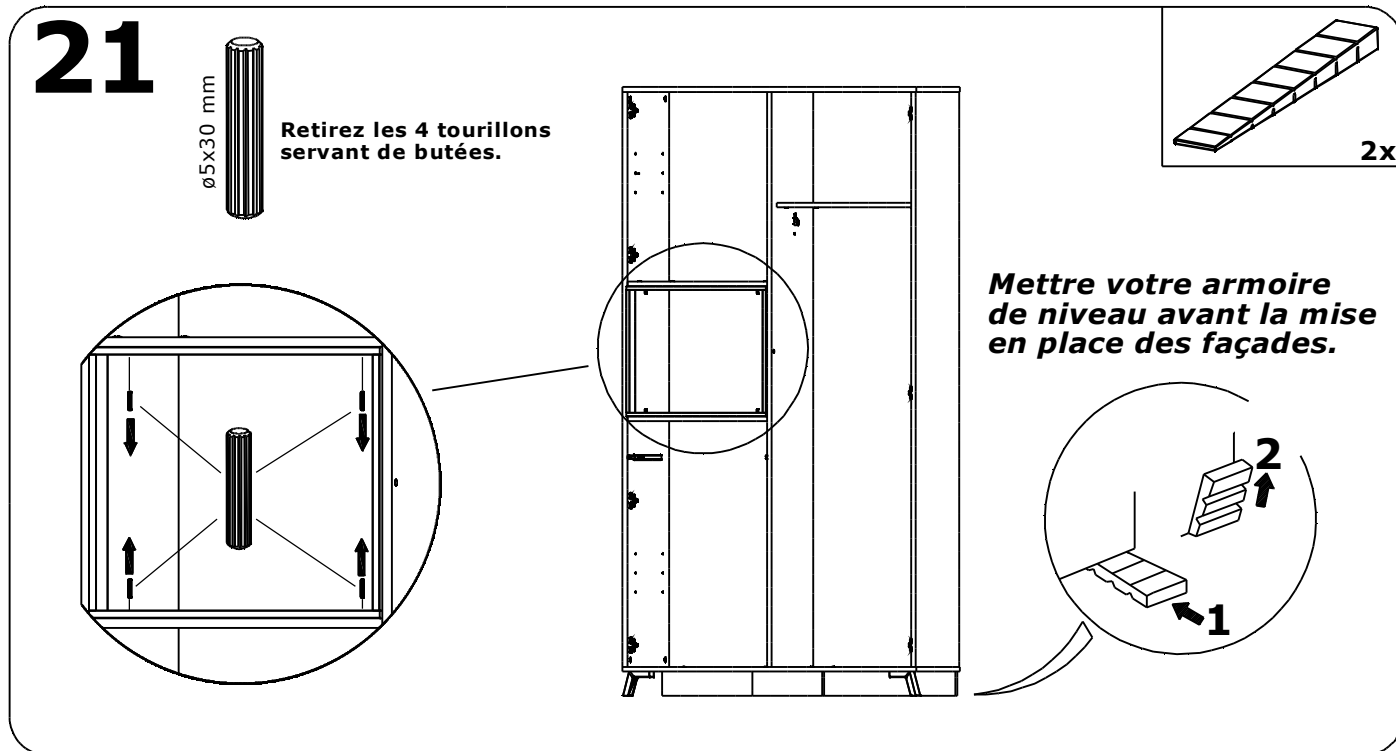

22

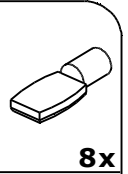
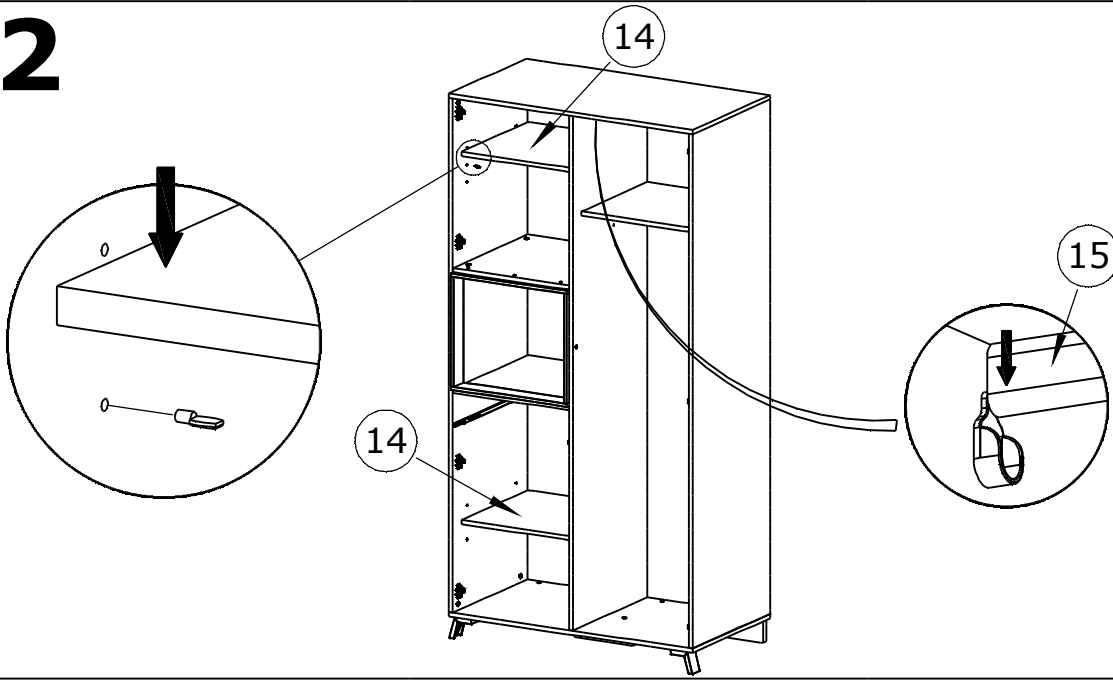

23

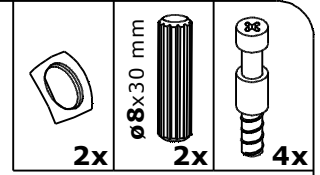
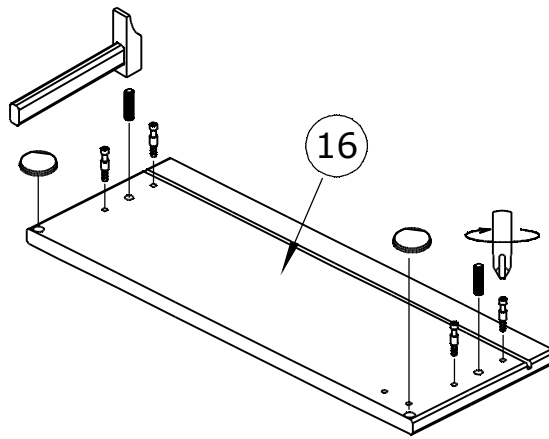

24

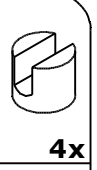
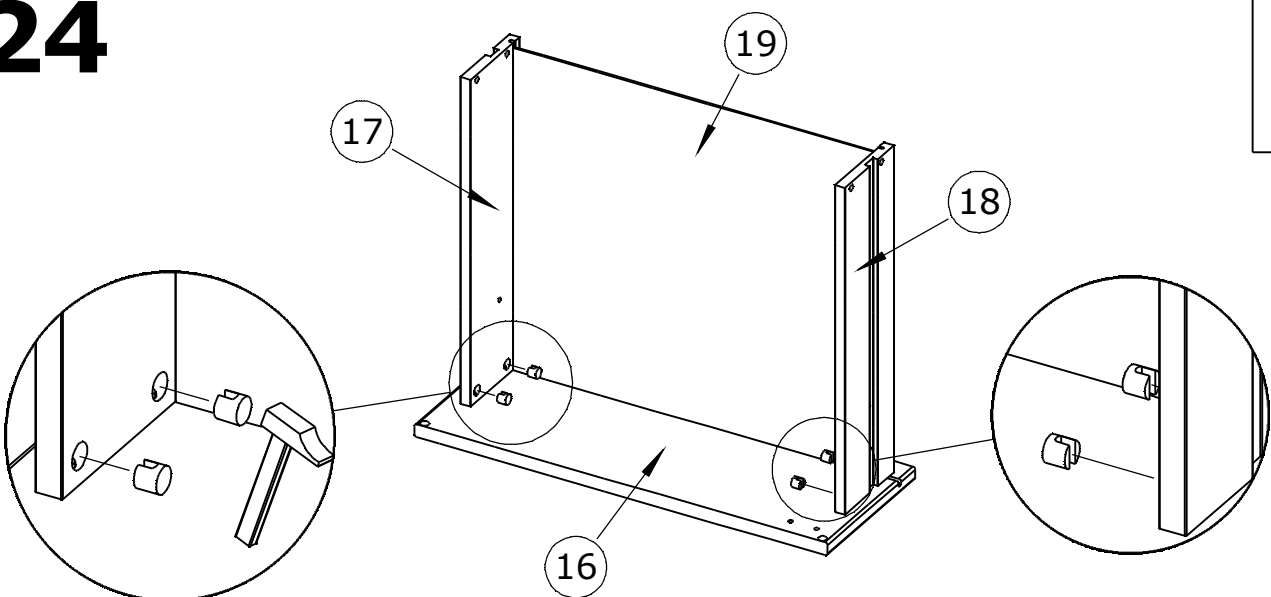

25

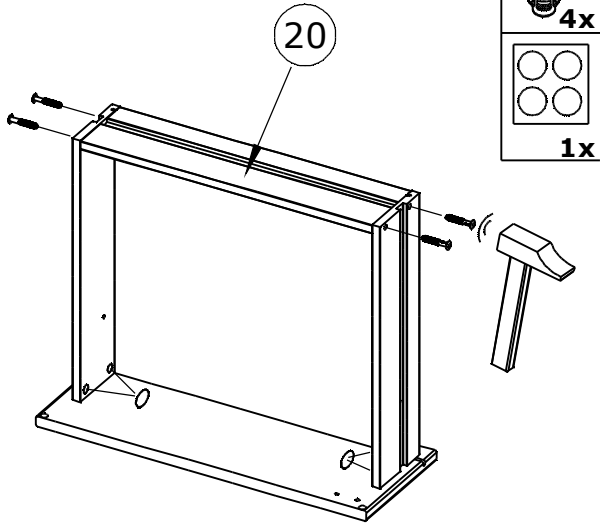

26

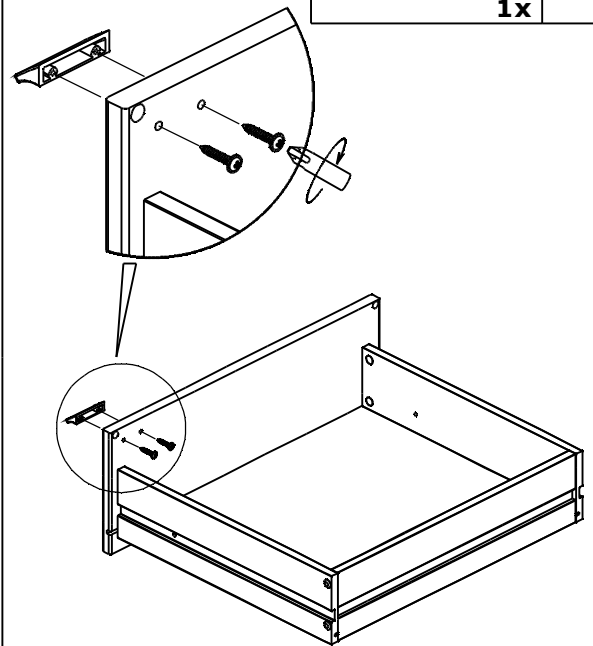

27

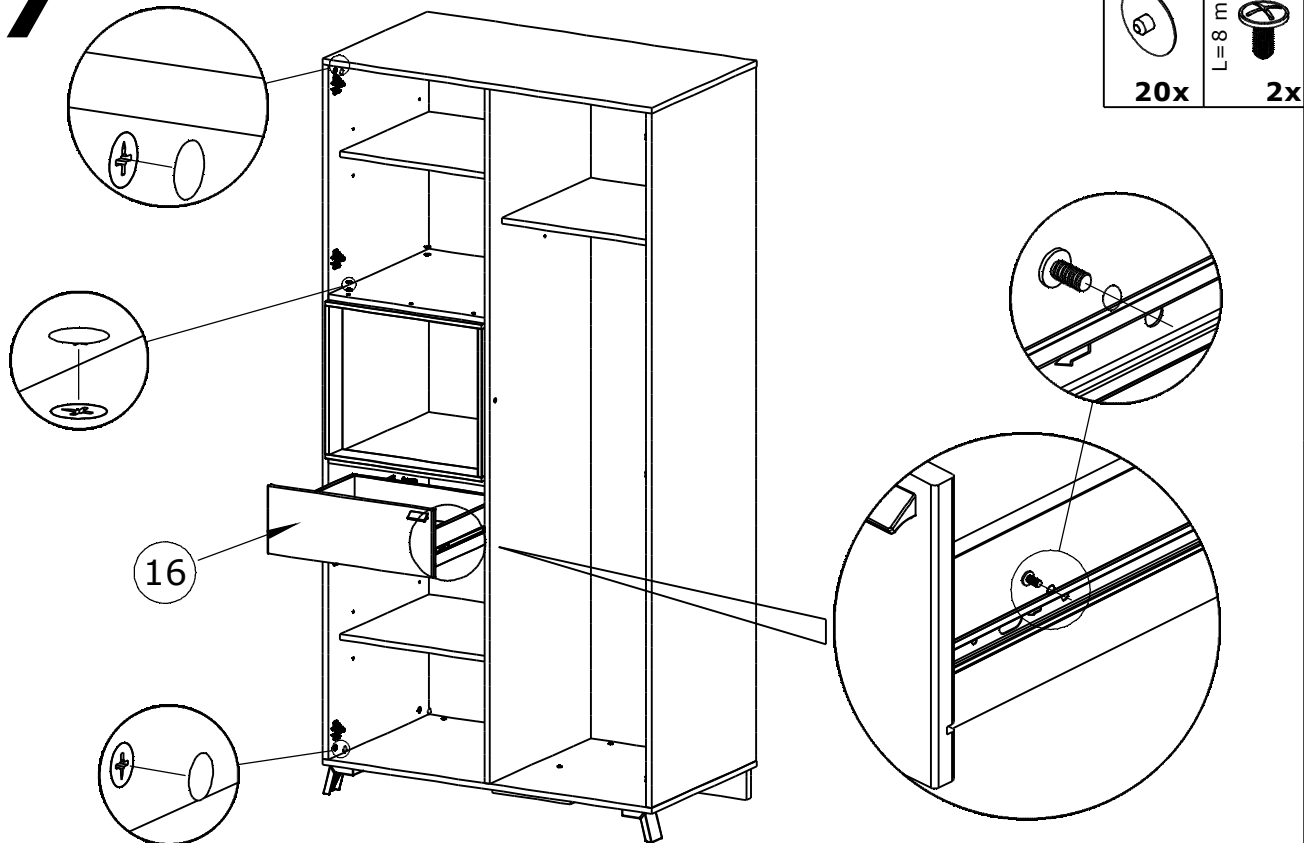

28

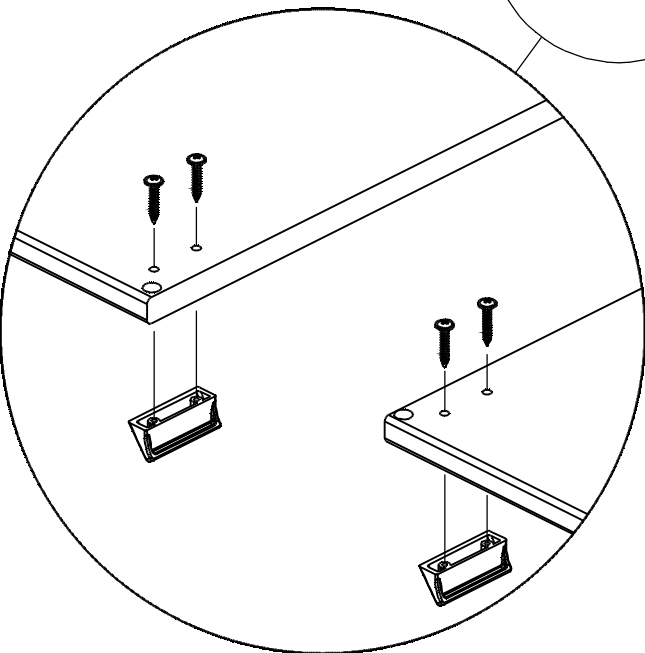
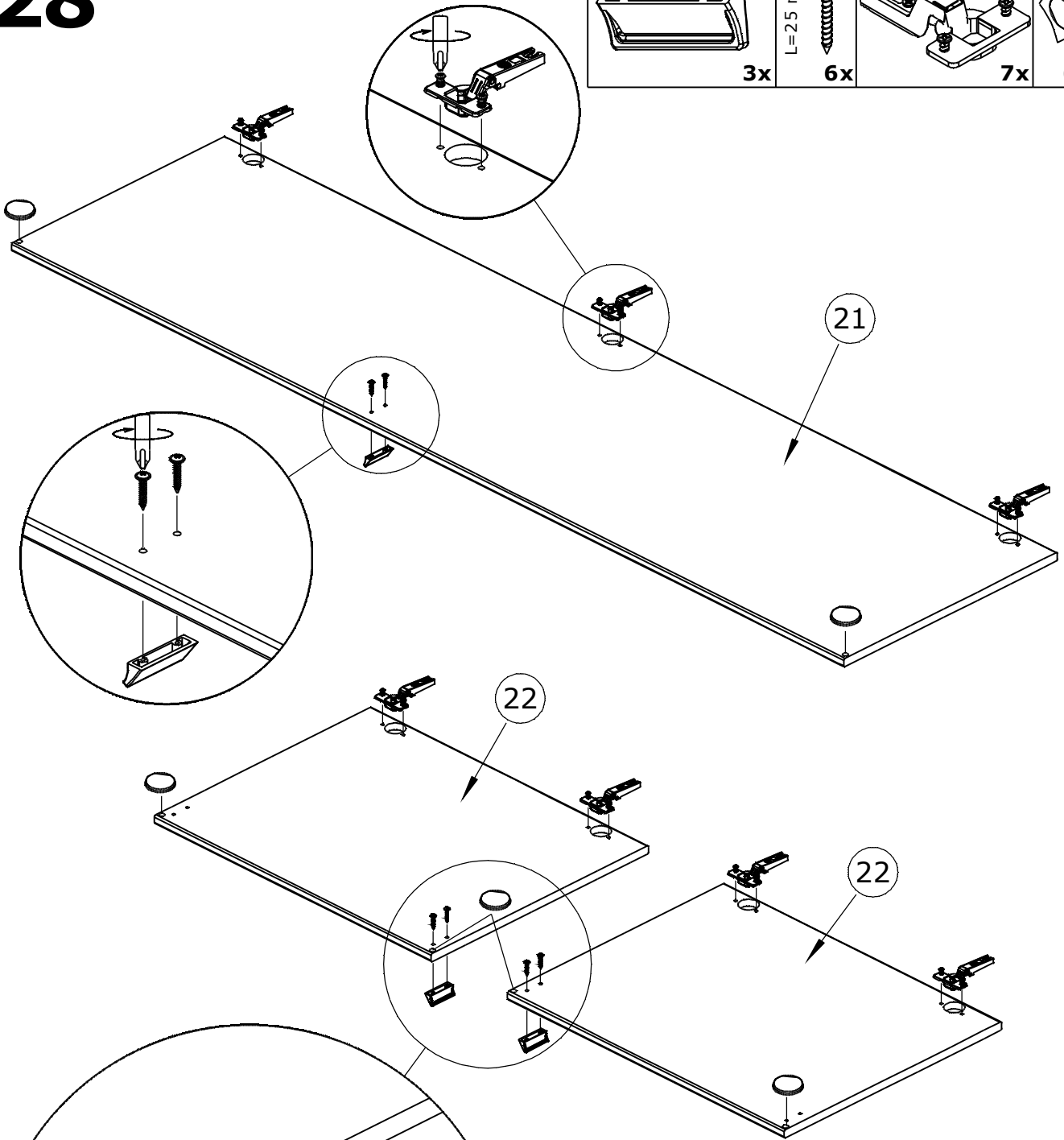
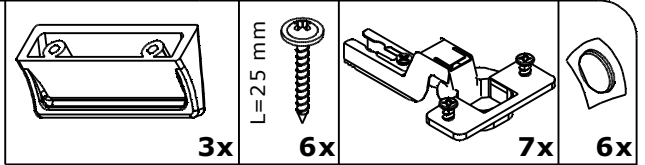

Débouchez les perçages $\varnothing 5$ mm des portes n°22 pour permettre la fixation des poignées.

CONSEIL DE PERÇAGE POUR LES POIGNÉES

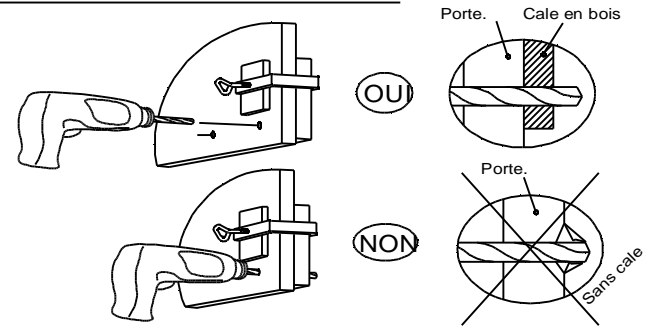

29

REGLAGE PORTES

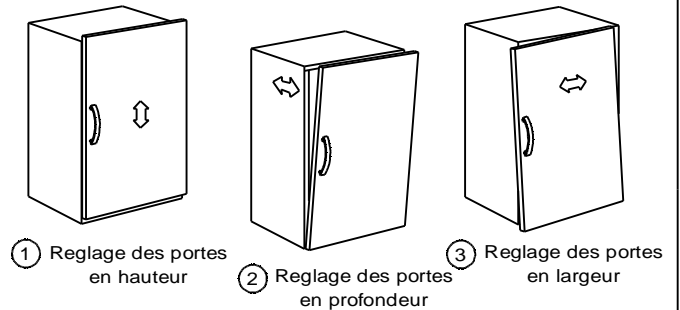
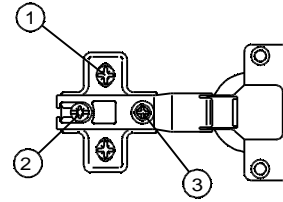
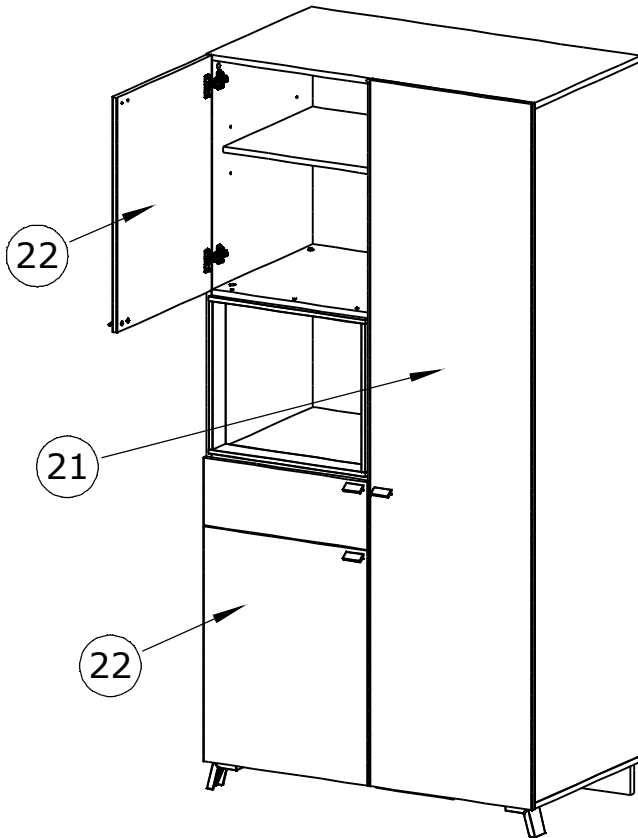

F CONSEILS D'ENTRETIEN :

- 1) Dépoussiérez soigneusement.
- 2) Humectez un chiffon doux et propre, d'eau légèrement savonneuse.
Ne jamais utiliser de produits abrasifs : poudre, laine d'acier, solvants.
Ne pas mouiller copieusement.

D PFLEGEHINWEISE :

- 1) Sorgfältig entstauben.
- 2) Mit einem weichen, sauberen und feuchten Tuch und leichter Seifenlauge reinigen. Benutzen Sie keine Scheuermittel wie Pulver, Stahlwolle, Lösungsmittel. Nicht zu nass abwischen.

GB NOTICE FOR MAINTENANCE :

- 1) Dust off carefully.
- 2) Use a soft, proper and humid duster and light soap solution to clean the furniture. Please do not use any scouring agent like powder, steel wool, solvents. Do not wet too much.

P NORMAS DE MANUTENCAO :

- 1) Eliminar bem o pó.
- 2) Umedecer um pano suave e limpo com água e um pouco de sabão. Nunca utilizar produtos abrasivos : pó, la de aço, solventes. Não molhar demasiado.

E RECOMENDACIONES PARA EL MANTENIMIENTO :

- 1) Despolvorear cuidadosamente.
- 2) Humedecer un pano suave y limpio con agua ligeramente enjabonada.
No use nunca productos abrasivos tales como : polvo de limpiar, lana de acero, solventes.
No mojar exageradamente.

I CONSIGLI PER LA MANUTENZIONE :

- 1) Spolverate accuratamente.
- 2) Inumidire con acqua leggermente insaponata uno straccio morbido e pulito. Non utilizzare mai prodotti abrasivi : polvere, lana di acciaio, solventi.
Non bagnare troppo.

PL WSKAZOWKI KONSERWACJI :

- 1) Zetrzeć dokładnie kurz.
- 2) Zwilżyć czystą i delikatną ściereczkę lekko mydlaną wodą. Nigdy nie używać produktów ściernych : proszków, drapaków, rozpuszczalników. Nie moczyć dużej ilości wody.